



KL-0326-160 E / -161 E

Hydraulic Press Tool Set, without Hydr. Cylinder



Product information

EN

 Read and understand before use!

www.gedore-automotive.com



GEDORE Automotive GmbH

Breslauer Straße 41
78166 - Donaueschingen
Postfach 1329
78154 Donaueschingen - GERMANY

+49 (0) 771 / 8 32 23-0
+49 (0) 771 / 8 32 23-90
info.gam@gedore.com
gedore-automotive.com

GEDORE TOOLS, INC.

Only for USA, Canada & Mexico / Sólo para EE.UU., Canadá y México
Seulement pour les USA, le Canada et le Mexique
7187 Bryhawke Circle, Suite 700
North Charleston, SC 29418, USA

+1-843 / 225 50 15
+1-843 / 225 50 20
info@gedoretools.com
gedore.com

Version 1 - 11/2021

0326-160E_161E_EN211107.indd

Product description

KL-0326-160 / - 161 - Hydraulic Press Tool Set, without Hydr. Cylinder

Applicable to Mercedes W201 (190 Series), W124 (E-Class), W211 (E-Class), W219 (CLS), W220 (S-Class), W230 (SL) and VWT4 (suspension ball joint, front axle); Mercedes W163 (M-Class) (suspension ball joint, front and rear axle); Mercedes W211 (E-Class), W219 (CLS), W220 (S-Class), W230 (SL) (upper ball joint, front axle).

The **KL-0326-160 E** hydraulic press tool set is designed to be used in conjunction with a hydraulic pump such as **KL-0215-35 M25** and the **KL-0040-2500** hydraulic cylinder, thus enabling lower and upper ball joints to be pressed into and pressed out of the lower wishbone quickly and without any trouble. The removal and installation of the suspension ball joints can sometimes also be carried out in situ on the vehicle within just a few minutes without the need for dismantling the wishbone.

The tool control foam insert of the **KL-4999-131.. Series** is designed to keep the tools of the **KL-0326-.. Tool Series** always properly organised and well protected. The module can conveniently be stored in a workshop trolley such as the **KL-4999-120** but also fits snugly in the robust stackable plastic storage cases of the **KL-4999-139.. Series**. This ingenious tool storage system from GEDORE Automotive allows you to find the tool you need quickly and easily, and to identify missing tools at a glance. As a result, repairs can be carried out more efficiently - saving you time and money. The foam insert is provided with specifically tool-shaped spaces to ensure that tools are safely stored and can be taken out and put back in place with ease.

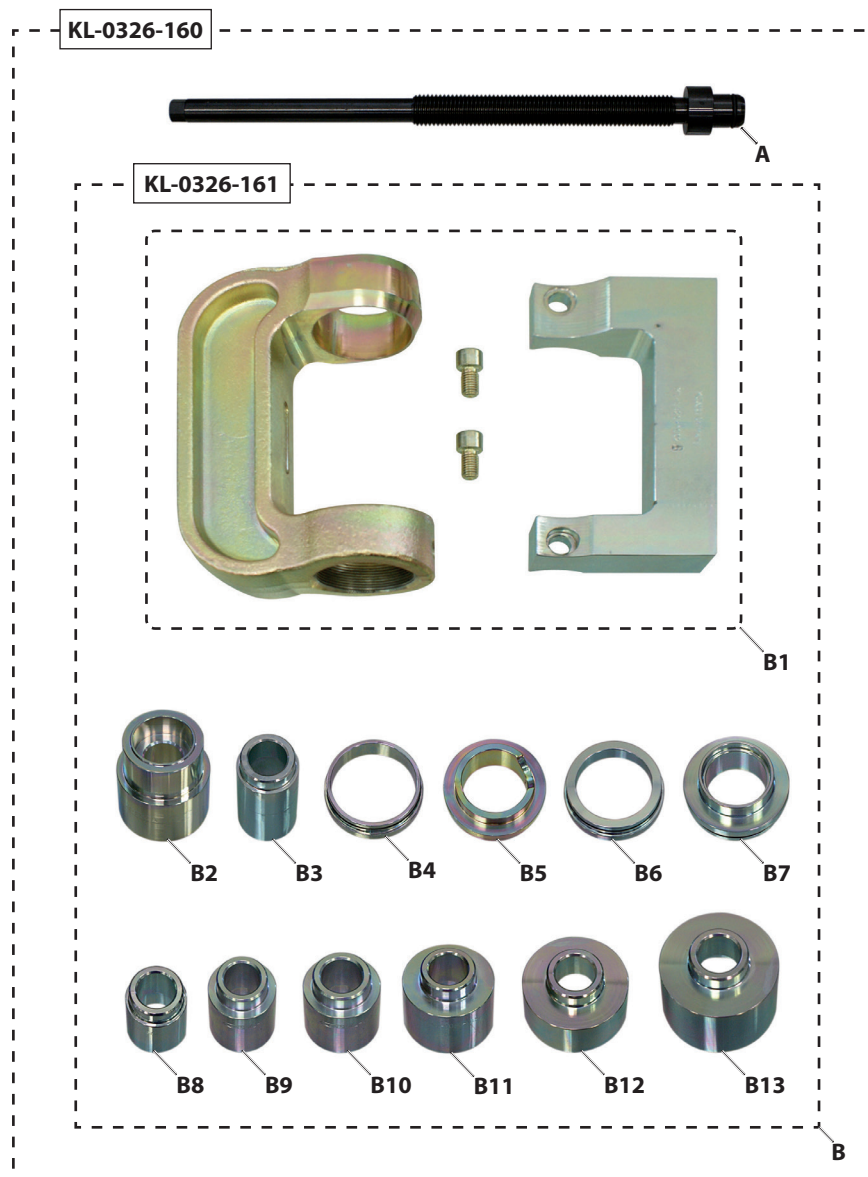

1: Application example



Scope of delivery/component overview

Pos.	Part no.	Description	Qty
A	KL-0039-1930	Pressure Spindle, M20 x 350	1
B	KL-0326-161	Hydraulic Press Tool Set, without Drive	1
B1	KL-0326-1000	Press Frame	1
B2	KL-0043-8662 A	Sleeve (top), VW T4	1
B3	KL-0350-5102	Pressure Sleeve	1
B4	KL-0326-1111	Adaptor Ring 1, with O-Ring	1
B5	KL-0326-1311	Adaptor Ring 3, with O-Ring	1
B6	KL-0326-1312 A	Adaptor Ring 4	1
B7	KL-0326-1411	Adaptor Ring 5, with O-Ring	1
B8	KL-0039-1634	Pressure/Support Sleeve, short, Ø 34/26mm	1
B9	KL-0039-1640	Pressure/Support Sleeve, short, Ø 40/32mm	1
B10	KL-0039-1642	Pressure/Support Sleeve, short, Ø 42/34mm	1
B11	KL-0039-1650	Pressure/Support Sleeve, short, Ø 50/42mm	1
B12	KL-0326-1314	Pressure/Support Sleeve, Ø 56/48mm	1
B13	KL-0326-1313 A	Pressure/Support Sleeve, Ø 60/52mm	1
-	KL-4999-1319	Foam Insert	1
i Tool Storage System: Plastic storage case - KL-4999-1393			

📖 : Observe the corresponding manuals!

The set covers the entire area of application of **KL 0326 10 A**, **KL 0326-14** and **KL-0326-15**.

Depending on the vehicle, the tools must be applied using the relevant manuals (see table below)!

Depending on the vehicle see manual:	Suitable for:
KL-0326-10 A	Suspension ball joint on Mercedes: W211 (E Class from 2002 onwards), W219 (CLS), W220 (S Class), W230 (SL), W124 (E Class), W201 (190 Series) front axle, and on W163 (M- Class) front/rear axle.
KL-0326-14	Suspension ball joint on Mercedes: W211 (E Class from 2002 onwards), W219 (CLS), W220 (S Class), W230 (SL) front axle.
KL-0326-15	Upper ball joint on VW T4, front axle

⚠ Safety instructions and regulations

- **Before using** the special tools, read and understand all safety instructions and **follow** them for **safe use**!
- Use the special tools **as intended** and **always** carry out maintenance and repair work in compliance with the regulations on occupational safety and accident prevention as well as the vehicle manufacturer's instructions!
- **Prior to each use**, check the special tools **carefully** for damage, loose parts or unauthorised modifications. **Never** use it if you notice any such deficiencies!
- **Always** wear your personal protective equipment (for example safety goggles, protective gloves, safety shoes) when working!

GEDORE-Werkzeugfabrik GmbH & Co. KG

Remscheider Straße 149
42899 - Remscheid
Postfach 120361
47873 Remscheid
GERMANY

Vertrieb DEUTSCHLAND

☎ +49 (0) 2191 / 596-0
☎ +49 (0) 2191 / 596-230
✉ info@gedore.com
🌐 www.gedore.com

Sales INTERNATIONAL

☎ +49 (0) 2191 / 596-910
☎ +49 (0) 2191 / 596-911
✉ info@gedore.com
🌐 www.gedore.com

GEDORE TOOLS, INC.

Only for USA, Canada & Mexico
Sólo para EE.UU., Canadá y México
Seulement pour les USA, le Canada et le Mexique
7187 Bryhawke Circle, Suite 700, North Charleston, SC 29418, USA

☎ +1-843 / 225 50 15
☎ +1-843 / 225 50 20
✉ info@gedoretools.com
🌐 www.gedoretools.com

Worldwide GEDORE service centers and offices are listed on the Internet at: www.gedore.com

GEDORE Automotive GmbH

Breslauer Straße 41
78166 - Donaueschingen
Postfach 1329
78154 Donaueschingen
GERMANY

Vertrieb DEUTSCHLAND

☎ +49 (0) 771 / 8 32 23-0
☎ +49 (0) 771 / 8 32 23-90
✉ info.gam@gedore.com
🌐 gedore-automotive.com



www.gedore-automotive.com